

Sri Rama Raksha!

Om Asmad Gurubhyo Namaha!  
SANKATA MOCHANA HANUMA

Sarva Jagad Raksha!



# SRI RAMA JAYA NIKETAN

(A Non Profit Organization Fed ID # 47-2362735)

## PANCHANGAM - 2021



**THE HINDU TEMPLE & COMMUNITY CENTRE**  
5500 Queenston Blvd, Houston, TX 77084.



Ph : 281-750-9199 | [info@sriramajaya.org](mailto:info@sriramajaya.org) | [www.sriramajaya.org](http://www.sriramajaya.org)



Sri Rama Raksha!

Om Asmad Gurubhyo Namaha!

Sarva Jagad Raksha!

SANKATA MOCHANA HANUMA

# Sri Rama Jaya Niketan

(A Non Profit Organization Fed ID # 47-2362735)

5500 Queenston Blvd, Houston, Tx 77084.

Ph: 281-750-9199 | info@sriramajaya.org | www.sriramajaya.org



Sri Lakshmi Narasimha

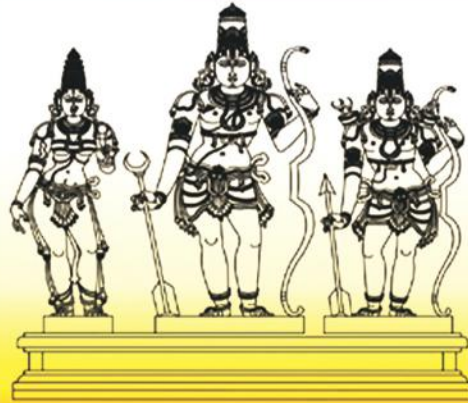

Sri Sita Ramachandra



Sri Sankata Mochana Hanuma



Sri Lakshmi Devi



Sri Lakshmi Venkateswara

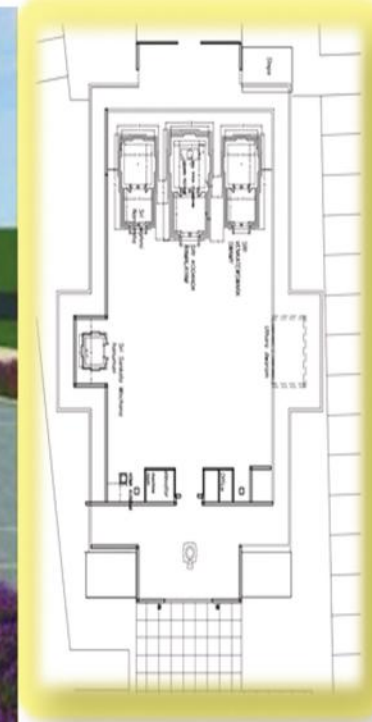



SUN

MON

TUE

WED

THU

FRI

SAT

31

Tritiya – 08:54  
Chaturthi – 30:54+  
Poorva Phalguni–13:48  
R.K – 16:38 to 17:59  
D.M – 16:32 to 17:15  
V – 20:36 to 22:07  
*Sankatahara Chaturthi*

**SRI RAMA JAYA NIKETAN**

[A Non Profit Organization Fed ID # 47-2362735]

**THE HINDHU TEMPLE & COMMUNITY CENTRE**

5500 Queenston Blvd, Houston, Tx 77084.

**TOGETHER WE BUILD A BETTER FUTURE**

*Your support is critical to create a world-class temple*

**PLEASE MAKE A PLEDGE**

1

*New Year Celebration*

Tritiya – 21:39  
Pushyami – 08:45  
R.K – 11:08 to 12:25  
D.M – 09:20 to 10:01  
12:46 to 13:27  
V – 21:34 to 23:10

2

Chaturthi – 20:52  
Ashlesha – 08:47  
R.K – 09:51 to 11:08  
D.M – 07:17 to 08:39  
V – 20:37 to 22:12  
*Sankatahara Chaturthi*

3

Panchami – 19:43  
Makha – 08:27  
R.K – 16:18 to 17:35  
D.M – 16:13 to 16:54  
V – 16:14 to 17:47

4

Shashthi – 18:16  
Poorva Phalguni–07:47  
Uttara Phalguni–30:51+  
R.K – 08:35 to 09:52  
D.M – 12:47 to 13:28  
14:51 to 15:32  
V – 14:42 to 16:15

5

Saptami – 16:33  
Hasta – 29:40+  
R.K – 15:02 to 16:19  
D.M – 09:21 to 10:03  
23:05 to 24:00  
V – 14:50 to 16:21

6

Ashtami – 14:36  
Chitra – 28:16+  
R.K – 12:27 to 13:45  
D.M – 12:07 to 12:48  
V – 13:12 to 14:42

7

Navami – 12:27  
Swati – 26:43+  
R.K – 13:45 to 15:03  
D.M – 10:45 to 11:26  
14:53 to 15:34  
V – 09:30 to 11:00

8

Dasami – 10:10  
Visakha – 25:02+  
R.K – 11:11 to 12:28  
D.M – 09:22 to 10:03  
12:49 to 13:30  
V – 07:55 to 09:25  
28:45+ to 30:14+  
*Saphala Ekadasi*

9

Ekadasi – 07:47  
Dwadasi – 29:22+  
Anuradha – 23:20  
R.K – 09:53 to 11:11  
D.M – 07:18 to 08:41  
V – 28:32+ to 30:02+

10

Thrayodasi – 27:02+  
Jyeshtha – 21:40  
R.K – 16:23 to 17:40  
D.M – 16:17 to 16:59  
V – 29:09+ to 30:39+  
*Pradosha Vratam*

11

Chaturdasi – 24:52+  
Moola – 20:08  
R.K – 08:36 to 09:54  
D.M – 12:50 to 13:32  
14:55 to 15:37  
V – 18:38 to 20:08  
29:13+ to 30:44+

12

Amavasya – 22:59  
Poorvashadha–18:52  
R.K – 15:06 to 16:24  
D.M – 09:23 to 10:04  
23:08 to 24:03+  
V – 26:34+ to 28:06+

13

*Bhogi, Lohri Pushya Masam Begins*

Pratipada – 21:31  
Uttharashadha – 17:58  
R.K – 12:30 to 13:48  
D.M – 12:09 to 12:51  
V – 21:54 to 23:29

14

*Pongal Makara Sankranti Uttarayanam Begins*

Dwitiya – 20:34  
Sravanam – 17:35  
R.K – 13:49 to 15:07  
D.M – 10:46 to 11:28  
14:57 to 15:39  
V – 21:37 to 23:14

15

*Kanuma Mattu Pongal*

Tritiya – 20:15  
Dhanishtha – 17:47  
R.K – 11:13 to 12:31  
D.M – 09:23 to 10:05  
12:52 to 13:34  
V – 25:15+ to 26:54+

16

Chaturthi – 20:38  
Satabhisha – 18:40  
R.K – 09:54 to 11:13  
D.M – 07:17 to 08:41  
V – 25:28+ to 27:11+

17

Panchami – 21:43  
Poorvabhadra – 20:13  
R.K – 16:28 to 17:46  
D.M – 16:22 to 17:04  
V – 30:42+ to 08:27

18

Shashthi – 23:28  
Uttarabhadra – 22:25  
R.K – 08:36 to 09:54  
D.M – 12:53 to 13:35  
14:59 to 15:41  
V – 06:42 to 08:27

19

Saptami – 25:44+  
Revati – 25:07+  
R.K – 15:10 to 16:29  
D.M – 09:23 to 10:05  
23:11 to 24:05+  
V – 11:46 to 13:32

20

Ashtami – 28:20+  
Aswini – 28:07+  
R.K – 12:33 to 13:52  
D.M – 12:12 to 12:54  
V – 23:37 to 25:25+

21

Navami – 30:59+  
Bharani – 31:10+  
R.K – 13:52 to 15:11  
D.M – 10:47 to 11:30  
15:01 to 15:43  
V – 14:56 to 16:44

22

Dasami – Full Night  
Krittika – Full Night  
R.K – 11:14 to 12:33  
D.M – 09:23 to 10:05  
12:54 to 13:37  
V – 20:37 to 22:24

23

Dasami – 09:26  
Krittika – 10:03  
R.K – 09:54 to 11:14  
D.M – 07:15 to 08:40  
V – 27:42+ to 29:28+

24

Ekadasi – 11:27  
Rohini – 12:31  
R.K – 16:33 to 17:52  
D.M – 16:27 to 17:10  
V – 18:34 to 20:18  
*Pousaputrada Ekadasi*

25

Dwadasi – 12:54  
Mrigasira – 14:26  
R.K – 08:34 to 09:54  
D.M – 12:55 to 13:38  
15:03 to 15:46  
V – 23:16 to 24:58+  
*Pradosha Vratam*

26

Thrayodasi – 13:41  
Arudra – 15:42  
R.K – 15:14 to 16:34  
D.M – 09:22 to 10:05  
23:14 to 24:07+  
V – 28:01+ to 29:39+

27

Chaturdasi – 13:47  
Punarvasu – 16:19  
R.K – 12:34 to 13:55  
D.M – 12:13 to 12:56  
V – 24:20+ to 25:56+

28

*Thai Poosam* ○  
Poornima – 13:15  
Pushyami – 16:21  
R.K – 13:55 to 15:15  
D.M – 10:47 to 11:30  
15:05 to 15:47  
V – 28:53+ to 30:27+

29

Pratipada – 12:11  
Ashlesha – 15:51  
R.K – 11:14 to 12:35  
D.M – 09:22 to 10:04  
12:56 to 13:39  
V – 27:25+ to 28:57+

30

Dwitiya – 10:42  
Makha – 14:58  
R.K – 09:54 to 11:14  
D.M – 07:12 to 08:38  
V – 22:35 to 24:06+



SUN MON TUE WED THU FRI SAT

<p><b>NOTE</b> R.K-RAHU KALAM D.M-DUR MUHURTHAM V-VARJYAM</p>	<p><b>1</b> Panchami – 28:49+ Uttara Phalguni-12:28 R.K-08:32 to 09:53 D.M – 12:57 to 13:40 15:06 to 15:50 V – 20:22 to 21:52</p>	<p><b>2</b> Shashthi – 26:42+ Hasta – 11:03 R.K – 15:18 to 16:39 D.M – 09:20 to 10:04 23:16 to 24:09+ V – 18:34 to 20:05</p>	<p><b>3</b> Saptami – 24:37+ Chitra – 09:38 R.K – 12:35 to 13:57 D.M – 12:14 to 12:57 V – 14:54 to 16:25</p>	<p><b>4</b> Ashtami – 22:37 Swati – 08:15 Visakha – 30:58+ R.K – 13:57 to 15:19 D.M – 10:47 to 11:30 15:08 to 15:51 V – 13:33 to 15:04</p>	<p><b>5</b> Navami – 20:43 Anuradha – 29:48+ R.K – 11:14 to 12:36 D.M – 09:19 to 10:03 12:57 to 13:41 V – 10:47 to 12:18</p>	<p><b>6</b> Dasami – 18:56 Jyeshtha – 28:45+ R.K – 09:52 to 11:14 D.M – 07:08 to 08:35 V – 11:09 to 12:41</p>
<p><b>7</b> Ekadasi – 17:17 Moola – 27:51+ R.K – 16:42 to 18:04 D.M – 16:37 to 17:21 V – 12:27 to 13:59 26:19+ to 27:51+ <i>Shattila Ekadasi</i></p>	<p><b>8</b> Dwadasi – 15:49 Poorvashadha-27:09+ R.K – 08:29 to 09:51 D.M – 12:58 to 13:42 15:10 to 15:53 V – 13:10 to 14:43 <i>Pradosha Vratam</i></p>	<p><b>9</b> Trayodasi – 14:35 Uttarashadha – 26:42+ R.K – 15:21 to 16:43 D.M – 09:18 to 10:02 23:18 to 24:10+ V – 11:00 to 12:34</p>	<p><b>10</b> Chaturdasi – 13:38 Sraavanam – 26:35+ R.K – 12:36 to 13:59 D.M – 12:14 to 12:58 V – 06:41 to 08:16 30:38+ to 08:15</p>	<p><b>11</b> <i>Thai Amavasya</i> ● Amavasya – 13:05 Dhanishtha – 26:53+ R.K – 13:59 to 15:22 D.M – 10:45 to 11:30 15:11 to 15:55 V – 06:38 to 08:15</p>	<p><b>12</b> <i>Kumbha Sankramanam Magha Masam Begins</i> Pratipada – 12:59 Satabhisha – 27:41+ R.K – 11:13 to 12:36 D.M – 09:16 to 10:01 12:58 to 13:42 V – 10:20 to 11:59</p>	<p><b>13</b> Dwitiya – 13:26 Poorvabhadra – 29:03+ R.K – 09:49 to 11:12 D.M – 07:02 to 08:31 V – 10:27 to 12:09</p>
<p><b>14</b> Tritiya – 14:28 Uttarabhadra-30:59+ R.K – 16:46 to 18:10 D.M – 16:41 to 17:25 V – 15:25 to 17:09</p>	<p><b>15</b> Chaturthi – 16:06 Revati – Full Night R.K – 08:24 to 09:48 D.M – 12:58 to 13:43 15:12 to 15:57 V – 20:13 to 21:59</p>	<p><b>16</b> <i>Vasanta Panchami Sri Panchami</i> Panchami – 18:16 Revati – 09:27 R.K – 15:24 to 16:48 D.M – 09:14 to 09:59 23:19 to 24:10+ V – NIL</p>	<p><b>17</b> Shashthi – 20:47 Aswini – 12:19 R.K – 12:36 to 14:00 D.M – 12:13 to 12:58 V – 07:50 to 09:38 23:09 to 24:57+</p>	<p><b>18</b> <i>Ratha Saptami Sri Soorya Jayanti</i> Saptami – 23:28 Bharani – 15:24 R.K – 14:00 to 15:24 D.M – 10:43 to 11:28 15:13 to 15:58 V – 28:56+ to 30:44+</p>	<p><b>19</b> Ashtami – 26:01+ Krittika – 18:28 R.K – 11:11 to 12:35 D.M – 09:12 to 09:58 12:58 to 13:43 V – 04:56 to 06:44</p>	<p><b>20</b> Navami – 28:12+ Rohini – 21:14 R.K – 09:46 to 11:11 D.M – 06:56 to 08:27 V – 12:18 to 14:05 27:21+ to 29:06+</p>
<p><b>21</b> Dasami – 29:46+ Mrigasira – 23:28 R.K – 16:50 to 18:15 D.M – 16:45 to 17:30 V – 03:21 to 05:06</p>	<p><b>22</b> <i>Bhishma Ekadasi</i> Ekadasi – 30:35+ Arudra – 25:01+ R.K – 08:19 to 09:45 D.M – 12:58 to 13:43 15:14 to 16:00 V – 08:25 to 10:07 <i>Jaya Ekadasi</i></p>	<p><b>23</b> Dwadasi – 30:35+ Punarvasu – 25:47+ R.K – 15:26 to 16:51 D.M – 09:10 to 09:55 23:19 to 24:09+ V – 13:24 to 15:03</p>	<p><b>24</b> Trayodasi – 29:48+ Pushyami – 25:47+ R.K – 12:35 to 14:00 D.M – 12:12 to 12:58 V – 09:47 to 11:23 <i>Pradosha Vratam</i></p>	<p><b>25</b> Chaturdasi – 28:19+ Aslesha – 25:05+ R.K – 14:01 to 15:26 D.M – 10:40 to 11:26 15:15 to 16:01 V – 14:13 to 15:46</p>	<p><b>26</b> <i>Maasi Magham</i> ○ Poornima – 26:16+ Makha – 23:48 R.K – 11:08 to 12:34 D.M – 09:08 to 09:54 12:57 to 13:43 V – 12:27 to 13:58</p>	<p><b>27</b> Pratipada – 23:48 Poorva Phalguni-22:06 R.K – 09:42 to 11:08 D.M – 06:49 to 08:21 V – 07:14 to 08:43 28:42+ to 30:10+</p>

**28**  
Dwitiya – 21:05  
Uttara Phalguni-20:07  
R.K – 16:54 to 18:20  
D.M – 16:48 to 17:34  
V – 27:47+ to 29:15+



**SRI RAMA JAYA NIKETAN**  
[A Non Profit Organization Fed ID # 47-2362735]  
**THE HINDHU TEMPLE & COMMUNITY CENTRE**  
5500 Queenston Blvd, Houston, Tx 77084.  
**TOGETHER WE BUILD A BETTER FUTURE**  
*Your support is critical to create a world-class temple*  
**PLEASE MAKE A PLEDGE**

Ph:281-750-9199  
info@sriramajaya.org  
www.sriramajaya.org



SUN	MON	TUE	WED	THU	FRI	SAT
<p><b>NOTE</b> R.K-RAHU KALAM D.M-DUR MUHURTHAM V-VARJYAM</p>	<p><b>1</b> Tritiya – 18:16 Hasta – 18:02 R.K – 08:14 to 09:40 D.M – 12:57 to 13:43 15:16 to 16:02 V-25:21+ to 26:49+ <i>Sankatahara Chaturthi</i></p>	<p><b>2</b> Chaturthi – 15:29 Chitra – 15:59 R.K – 15:28 to 16:55 D.M – 09:05 to 09:51 23:19 to 24:08+ V – 21:09 to 22:37</p>	<p><b>3</b> Panchami – 12:51 Swati – 14:06 R.K – 12:34 to 14:01 D.M – 12:10 to 12:57 V – 19:19 to 20:48</p>	<p><b>4</b> Shashthi – 10:28 Visakha – 12:28 R.K – 14:01 to 15:28 D.M – 10:37 to 11:23 15:17 to 16:03 V – 16:14 to 17:45</p>	<p><b>5</b> Saptami – 08:24 Ashtami – 30:40+ Anuradha – 11:08 R.K – 11:05 to 12:33 D.M – 09:03 to 09:49 12:56 to 13:43 V – 16:30 to 18:02</p>	<p><b>6</b> Navami – 29:17+ Jyeshtha – 10:08 R.K – 09:37 to 11:05 D.M – 06:41 to 08:15 V – 17:55 to 19:29</p>
<p><b>7</b> Dasami – 28:14+ Moola – 09:29 R.K – 16:57 to 18:25 D.M – 16:51 to 17:38 V – 07:56 to 09:29 18:58 to 20:32</p>	<p><b>8</b> Ekadasi – 27:32+ Poorvashadha – 09:10 R.K – 08:07 to 09:36 D.M – 12:56 to 13:43 15:17 to 16:04 V – 17:11 to 18:47 <i>Vijaya Ekadasi</i></p>	<p><b>9</b> Dwadasi – 27:10+ Uttarashadha – 09:12 R.K – 15:29 to 16:58 D.M – 09:00 to 09:47 23:18 to 24:07+ V – 13:15 to 14:53</p>	<p><b>10</b> Trayodasi – 27:09+ Sraavanam – 09:33 R.K – 12:32 to 14:01 D.M – 12:08 to 12:56 V – 13:40 to 15:19 <i>Pradosha Vratam</i></p>	<p><b>11</b> <i>Maha Sivaratri</i> Chaturdasi – 27:32+ Dhanishtha – 10:15 R.K – 14:01 to 15:30 D.M – 10:33 to 11:20 15:18 to 16:05 V – 17:47 to 19:28</p>	<p><b>12</b> Amavasya – 28:20+ Satabhisha – 11:21 R.K – 11:02 to 12:31 D.M – 08:57 to 09:45 12:55 to 13:43 V – 18:09 to 19:51</p>	<p><b>13</b> <i>Phalguna Masam Begins</i> Pratipada – 30:36+ Poorvabhadra – 12:52 R.K – 09:32 to 11:02 D.M – 06:33 to 08:09 V – 23:15 to 24:59+</p>
<p><b>14</b> <i>Meena Sankramanam Karadaiyan Nombu</i> Dwitiya – Full Night Uttarabhadra – 15:50 R.K – 18:00 to 19:29 D.M – 17:54 to 18:42 V – 29:02+ to 30:47+</p>	<p><b>15</b> Dwitiya – 08:19 Revati – 18:14 R.K – 09:01 to 10:31 D.M – 13:54 to 14:42 16:18 to 17:06 V – 05:02 to 06:47</p>	<p><b>16</b> Tritiya – 10:28 Aswini – 21:01 R.K – 16:30 to 18:01 D.M – 09:54 to 10:42 24:18+ to 25:06+ V – 16:33 to 18:20</p>	<p><b>17</b> Chaturthi – 12:58 Bharani – 24:05+ R.K – 13:30 to 15:00 D.M – 13:06 to 13:54 V – 07:51 to 09:39</p>	<p><b>18</b> Panchami – 15:39 Krittika – 27:14+ R.K – 15:00 to 16:31 D.M – 11:29 to 12:17 16:19 to 17:07 V – 13:40 to 15:28</p>	<p><b>19</b> Shashthi – 18:18 Rohini – 30:16+ R.K – 11:59 to 13:29 D.M – 09:51 to 10:40 13:54 to 14:42 V – 21:15 to 23:03</p>	<p><b>20</b> Saptami – 20:39 Mrigasira – Full Night R.K – 10:27 to 11:58 D.M – 07:25 to 09:02 V – 12:29 to 14:15</p>
<p><b>21</b> Ashtami – 22:30 Mrigasira – 08:55 R.K – 18:03 to 19:34 D.M – 17:56 to 18:45 V – 18:02 to 19:46</p>	<p><b>22</b> Navami – 23:37 Arudra – 10:58 R.K – 08:54 to 10:26 D.M – 13:53 to 14:42 16:19 to 17:08 V – 23:37 to 25:18+</p>	<p><b>23</b> Dasami – 23:53 Punarvasu – 12:16 R.K – 16:32 to 18:03 D.M – 09:48 to 10:37 24:17+ to 25:04+ V – 20:25 to 22:02</p>	<p><b>24</b> Ekadasi – 23:17 Pushyami – 12:42 R.K – 13:28 to 15:00 D.M – 13:03 to 13:52 V – 25:18+ to 26:52+ <i>Amalaki Ekadasi</i></p>	<p><b>25</b> Dwadasi – 21:51 Ashlesha – 12:19 R.K – 15:00 to 16:32 D.M – 11:25 to 12:14 16:20 to 17:09 V – 23:44 to 25:16+</p>	<p><b>26</b> Trayodasi – 19:41 Makha – 11:10 R.K – 11:55 to 13:27 D.M – 09:46 to 10:35 13:52 to 14:41 V – 18:34 to 20:02 <i>Pradosha Vratam</i></p>	<p><b>27</b> <i>Holi</i> Chaturdasi – 16:56 Poorva Phalguni – 09:22 Uttara Phalguni – 31:06+ R.K – 10:22 to 11:54 D.M – 07:17 to 08:55 V – 15:53 to 17:20</p>
<p><b>28</b> <i>Sri Mahalakshmi Jayanti Panguni Uttaram</i> Poornima – 13:47 Hasta – 28:32+ R.K – 18:05 to 19:38 D.M – 17:59 to 18:48 V – 14:36 to 16:02</p>	<p><b>29</b> Pratipada – 10:24 Dwitiya – 30:57+ Chitra – 25:52+ R.K – 08:47 to 10:20 D.M – 13:51 to 14:41 16:20 to 17:10 V – 11:39 to 13:04</p>	<p><b>30</b> Tritiya – 27:36+ Swati – 23:15 R.K – 16:33 to 18:06 D.M – 09:42 to 10:32 24:16+ to 25:02+ V – 06:51 to 08:17 28:18+ to 29:44+</p>	<p><b>31</b> Chaturthi – 24:29+ Visakha – 20:52 R.K – 13:26 to 14:59 D.M – 13:01 to 13:51 V – 24:31+ to 25:59+ <i>Sankatahara Chaturthi</i></p>	<p><b>SRI RAMA JAYA NIKETAN</b> (A Non Profit Organization Fed ID # 47-2362735) <b>THE HINDHU TEMPLE &amp; COMMUNITY CENTRE</b> 5500 Queenston Blvd, Houston, Tx 77084. TOGETHER WE BUILD A BETTER FUTURE <i>Your support is critical to create a world-class temple</i> <b>PLEASE MAKE A PLEDGE</b></p>		



SUN

MON

TUE

WED

THU

FRI

SAT

**SRI RAMA JAYA NIKETAN**

(A Non Profit Organization Fed ID # 47-2362735)

**THE HINDHU TEMPLE & COMMUNITY CENTRE**

5500 Queenston Blvd, Houston, Tx 77084.

TOGETHER WE BUILD A BETTER FUTURE

Your support is critical to create a world-class temple

PLEASE MAKE A PLEDGE

NOTE  
R.K-RAHU KALAM  
D.M-DUR MUHURTHAM  
V-VARJYAM

1

Panchami – 21:45  
Anuradha – 18:49  
R.K – 14:59 to 16:33  
D.M – 11:20 to 12:10  
16:20 to 17:10  
V – 24:03+ to 25:33+

2

Shashthi – 19:28  
Jyeshtha – 17:14  
R.K – 11:51 to 13:25  
D.M – 09:40 to 10:30  
13:50 to 14:40  
V – 24:52+ to 26:24+

3

Saptami – 17:42  
Moola – 16:09  
R.K – 10:17 to 11:51  
D.M – 07:08 to 08:49  
V – 14:37 to 16:09  
25:32+ to 27:05+

4

Ashtami – 16:29  
Poorvashadha – 15:36  
R.K – 18:08 to 19:42  
D.M – 18:01 to 18:52  
V – 23:36 to 25:12+

5

Navami – 15:48  
Uttarashadha – 15:35  
R.K – 08:40 to 10:15  
D.M – 13:50 to 14:40  
16:21 to 17:11  
V – 19:40 to 21:18

6

Dasami – 15:39  
Sraavanam – 16:05  
R.K – 16:34 to 18:08  
D.M – 09:36 to 10:27  
24:15+ to 25:01+  
V – 20:14 to 21:54

7

Ekadasi – 15:58  
Dhanishta – 17:03  
R.K – 13:24 to 14:59  
D.M – 12:58 to 13:49  
V – 24:40+ to 26:22+  
Papamochani Ekadasi

8

Dwadasi – 16:45  
Satabhisha – 18:28  
R.K – 14:59 to 16:34  
D.M – 11:16 to 12:07  
16:21 to 17:12  
V – 25:21+ to 27:04+  
Pradosha Vratam

9

Trayodasi – 17:57  
Poorvabhada – 20:16  
R.K – 11:48 to 13:23  
D.M – 09:34 to 10:25  
13:49 to 14:40  
V – 30:45+ to 08:30

10

Chaturdasi – 19:33  
Uttarabhada – 22:28  
R.K – 10:12 to 11:47  
D.M – 07:00 to 08:42  
V – 06:45 to 08:30

11

Amavasya – 21:30  
Revati – 25:00+  
R.K – 18:10 to 19:46  
D.M – 18:04 to 18:55  
V – 11:44 to 13:30

12

Ugadi  
Sri Plava Nama  
Samvatsaram  
Gudi Padwa  
Chaitra Masam Begins  
Pratipada – 23:46  
Aswini – 27:50+  
R.K – 08:34 to 10:10  
D.M – 13:48 to 14:39  
16:22 to 17:13  
V – 23:21 to 25:09+

13

Mesha  
Sankramanam  
Tamil New Year  
Dwitiya – 26:17+  
Bharani – 30:53+  
R.K – 16:35 to 18:11  
D.M – 09:31 to 10:22  
24:15+ to 24:59+  
V – 14:39 to 16:27

14

Vishukani  
Tritiya – 28:57+  
Krittika – Full Night  
R.K – 13:22 to 14:58  
D.M – 12:56 to 13:48  
V – 20:28 to 22:16

15

Chaturthi – Full Night  
Krittika – 10:03  
R.K – 14:58 to 16:35  
D.M – 11:13 to 12:04  
16:22 to 17:14  
V – 28:08+ to 29:56+

16

Chaturthi – 07:35  
Rohini – 13:10  
R.K – 11:44 to 13:21  
D.M – 09:29 to 10:20  
13:47 to 14:39  
V – 19:27 to 21:14

17

Panchami – 10:02  
Mrigasira – 16:04  
R.K – 10:07 to 11:44  
D.M – 06:52 to 08:36  
V – 25:20+ to 27:05+

18

Shashthi – 12:04  
Arudra – 18:32  
R.K – 18:13 to 19:51  
D.M – 18:07 to 18:59  
V – 07:30 to 09:16

19

Saptami – 13:31  
Punarvasu – 20:23  
R.K – 08:28 to 10:06  
D.M – 13:47 to 14:39  
16:23 to 17:15  
V – 07:27 to 09:11

20

Ashtami – 14:13  
Pushyami – 21:29  
R.K – 16:36 to 18:14  
D.M – 09:26 to 10:18  
24:14+ to 24:58+  
V – 04:45 to 06:25

21

Sri Rama  
Navami  
Navami – 14:05  
Aslesha – 21:45  
R.K – 13:20 to 14:58  
D.M – 12:54 to 13:46  
V – 10:26 to 12:03

22

Dasami – 13:05  
Makha – 21:12  
R.K – 14:58 to 16:37  
D.M – 11:09 to 12:02  
16:24 to 17:16  
V – 09:29 to 11:02  
28:45+ to 30:16+

23

Ekadasi – 11:17  
Poorva Phalguni – 19:52  
R.K – 11:42 to 13:20  
D.M – 09:24 to 10:16  
13:46 to 14:39  
V – 26:29+ to 27:57+  
Kamada Ekadasi

24

Dwadasi – 08:47  
Trayodasi – 29:42+  
Uttara Phalguni – 17:54  
R.K – 10:02 to 11:41  
D.M – 06:45 to 08:30  
V – 25:25+ to 26:52+  
Pradosha Vratam

25

Chaturdasi – 26:14+  
Hasta – 15:25  
R.K – 18:16 to 19:55  
D.M – 18:10 to 19:02  
V – 22:28 to 23:53

26

(Tamil)  
Hanumajjayanti  
Poornima – 22:31  
Chitra – 12:36  
R.K – 08:22 to 10:01  
D.M – 13:46 to 14:39  
16:24 to 17:17  
V – 17:31 to 18:55

27

Pratipada – 18:44  
Swati – 09:38  
R.K – 16:38 to 18:17  
D.M – 09:21 to 10:14  
24:14+ to 24:57+  
V – 14:33 to 15:58

28

Dwitiya – 15:04  
Visakha – 06:43  
Anuradha – 27:59+  
R.K – 13:19 to 14:59  
D.M – 12:53 to 13:46  
V – 10:16 to 11:41

29

Tritiya – 11:39  
Jyeshtha – 25:38+  
R.K – 14:59 to 16:38  
D.M – 11:06 to 11:59  
16:25 to 17:18  
V – 09:02 to 10:29  
Sankatahara Chaturthi

30

Chaturthi – 08:39  
Panchami – 30:11+  
Moola – 23:46  
R.K – 11:39 to 13:19  
D.M – 09:19 to 10:13  
13:45 to 14:39  
V – 09:00 to 10:29  
22:17 to 23:46

Ph:281-750-9199  
info@sriramajaya.org  
www.sriramajaya.org



SUN MON TUE WED THU FRI SAT

**30**  
Panchami – 15:42  
Sraavanam – 29:32+  
R.K – 18:32 to 20:17  
D.M – 18:25 to 19:21  
V – 10:05 to 11:38

**31**  
Shashthi – 14:35  
Dhanishtha – 29:38+  
R.K – 08:06 to 09:50  
D.M – 13:47 to 14:43  
16:34 to 17:30  
V – 09:33 to 11:09

**SRI RAMA JAYA NIKETAN**  
[A Non Profit Organization Fed ID # 47-2362735]  
**THE HINDHU TEMPLE & COMMUNITY CENTRE**  
5500 Queenston Blvd, Houston, Tx 77084.  
**TOGETHER WE BUILD A BETTER FUTURE**  
*Your support is critical to create a world-class temple*  
**PLEASE MAKE A PLEDGE**

**NOTE**  
R.K–RAHU KALAM  
D.M–DUR MUHURTHAM  
V–VARJYAM

**1**  
Shashthi – 28:20+  
Poorvashadha – 22:29  
R.K – 09:59 to 11:39  
D.M – 06:39 to 08:25  
V – 08:51 to 10:22

**2**  
Saptami – 27:09+  
Uttarashadha – 21:52  
R.K – 18:19 to 19:59  
D.M – 18:13 to 19:06  
V – 06:17 to 07:50  
25:53+ to 27:29+

**3**  
Ashtami – 26:40+  
Sraavanam – 21:56  
R.K – 08:17 to 09:58  
D.M – 13:45 to 14:39  
16:26 to 17:19  
V – 26:04+ to 27:43+

**4**  
Navami – 26:51+  
Dhanishtha – 22:41  
R.K – 16:40 to 18:20  
D.M – 09:17 to 10:11  
24:15+ to 24:57+  
V – 30:17+ to 07:59

**5**  
Dasami – 27:40+  
Satabhisha – 24:02+  
R.K – 13:18 to 14:59  
D.M – 12:51 to 13:45  
V – 06:17 to 07:59

**6**  
Ekadasi – 29:02+  
Poorvabhadrā – 25:56+  
R.K – 14:59 to 16:40  
D.M – 11:04 to 11:58  
16:27 to 17:20  
V – 06:57 to 08:40  
*Varudhini Ekadasi*

**7**  
Dwadasi – Full Night  
Uttarabhadrā – 28:17+  
R.K – 11:37 to 13:18  
D.M – 09:16 to 10:09  
13:45 to 14:39  
V – 12:29 to 14:14

**8 Sani Trayodasi**  
Dwadasi – 06:50  
Revati – Full Night  
R.K – 09:56 to 11:37  
D.M – 06:33 to 08:21  
V – 17:38 to 19:25  
*Pradosha Vratam*

**9**  
Thrayodasi – 09:00  
Revati – 06:59  
R.K – 18:22 to 20:04  
D.M – 18:16 to 19:10  
V – 29:26+ to 07:14

**10**  
Chaturdasi – 11:25  
Aswini – 09:56  
R.K – 08:13 to 09:55  
D.M – 13:45 to 14:39  
16:28 to 17:22  
V – 05:26 to 07:14  
20:46 to 22:34

**11** ●  
Amavasya – 13:59  
Bharani – 13:01  
R.K – 16:42 to 18:23  
D.M – 09:14 to 10:08  
24:15+ to 24:57+  
V – 26:36+ to 28:24+

**12** Vaisakha  
Masam Begins  
Pratipada – 16:35  
Krittika – 16:10  
R.K – 13:18 to 15:00  
D.M – 12:51 to 13:45  
V – 02:36 to 04:24

**13**  
Dwitiya – 19:08  
Rohini – 19:15  
R.K – 15:00 to 16:42  
D.M – 11:02 to 11:56  
16:29 to 17:23  
V – 10:14 to 12:02

**14 Akshaya Tritiya**  
Parasurama Jayanti  
Vrishabha Sankramanam  
Tritiya – 21:29  
Mrigasira – 22:09  
R.K – 11:36 to 13:18  
D.M – 09:13 to 10:07  
13:45 to 14:40  
V – 01:32 to 03:19

**15 Sri Ramanujacharya**  
Jayanti  
Chaturthi – 23:30  
Arudra – 24:44+  
R.K – 09:53 to 11:36  
D.M – 06:28 to 08:18  
V – 07:27 to 09:14

**16 Sri Sankaracharya**  
Jayanti  
Panchami – 25:04+  
Punarvasu – 26:52+  
R.K – 18:26 to 20:08  
D.M – 18:19 to 19:14  
V – 13:48 to 15:33

**17**  
Shashthi – 26:02+  
Pushyami – 28:25+  
R.K – 08:10 to 09:53  
D.M – 13:45 to 14:40  
16:30 to 17:25  
V – 11:23 to 13:05

**18**  
Saptami – 26:20+  
Ashlesha – 29:18+  
R.K – 16:44 to 18:27  
D.M – 09:11 to 10:06  
24:16+ to 24:57+  
V – 17:42 to 19:21

**19**  
Ashtami – 25:53+  
Makha – 29:28+  
R.K – 13:18 to 15:01  
D.M – 12:51 to 13:46  
V – 17:23 to 19:00

**20**  
Navami – 24:40+  
Poorva Phalguni – 28:53+  
R.K – 15:01 to 16:44  
D.M – 11:01 to 11:56  
16:31 to 17:26  
V – 13:16 to 14:50

**21 Vasavi Kanyaka**  
Parameswari  
Jayanti  
Dasami – 22:45  
Uttara Phalguni – 27:36+  
R.K – 11:35 to 13:18  
D.M – 09:10 to 10:05  
13:46 to 14:41  
V – 11:42 to 13:12

**22**  
Ekadasi – 20:12  
Hasta – 25:42+  
R.K – 09:51 to 11:35  
D.M – 06:25 to 08:15  
V – 11:20 to 12:49  
*Mohini Ekadasi*

**23**  
Dwadasi – 17:08  
Chitra – 23:19  
R.K – 18:29 to 20:13  
D.M – 18:22 to 19:17  
V – 08:55 to 10:21  
*Pradosha Vratam*

**24 Sri Narasimha**  
Jayanti  
Trayodasi – 13:41  
Swati – 20:36  
R.K – 08:07 to 09:51  
D.M – 13:46 to 14:41  
16:32 to 17:27  
V – 04:17 to 05:42

**25 Vaikasi**  
Visaakham ○  
Chaturdasi – 09:59  
Poornima – 30:13+  
Visakha – 17:41  
R.K – 16:46 to 18:30  
D.M – 09:09 to 10:05  
24:17+ to 24:58+  
V – 01:31 to 02:55  
21:12 to 22:36

**26 Chandra Grahnam**  
03:47 a.m  
to 6.28 a.m  
Pratipada – 26:32+  
Anuradha – 14:46  
R.K – 13:19 to 15:03  
D.M – 12:51 to 13:46  
V – 19:43 to 21:08

**27**  
Dwitiya – 23:06  
Jyeshtha – 11:59  
R.K – 15:03 to 16:47  
D.M – 11:00 to 11:56  
16:33 to 17:28  
V – 19:10 to 20:37

**28**  
Tritiya – 20:03  
Moola – 09:32  
R.K – 11:35 to 13:19  
D.M – 09:09 to 10:04  
13:47 to 14:42  
V – 08:06 to 09:32  
18:21 to 19:49  
*Sankatahara Chaturthi*

**29**  
Chaturthi – 17:33  
Poorvashadha – 07:34  
Uttarashadha – 30:12+  
R.K – 09:51 to 11:35  
D.M – 06:22 to 08:13  
V – 15:06 to 16:37



SUN	MON	TUE	WED	THU	FRI	SAT
<p>Ph:281-750-9199 info@sriramajaya.org www.sriramajaya.org</p>	<p><b>NOTE</b> R.K-RAHU KALAM D.M-DUR MUHURTHAM V-VARJYAM</p>	<p><b>1</b> Saptami – 14:16 Satabhisha-Full Night R.K – 16:49 to 18:33 D.M – 09:09 to 10:04 24:19+ to 24:59+ V – 13:05 to 14:45</p>	<p><b>2</b> Ashtami – 14:42 Satabhisha – 06:30 R.K – 13:20 to 15:04 D.M – 12:52 to 13:48 V – 13:19 to 15:01</p>	<p><b>3</b> Navami – 15:52 Poorvabhadrā-08:05 R.K – 15:04 to 16:49 D.M – 11:00 to 11:56 16:35 to 17:31 V – 18:34 to 20:19</p>	<p><b>4 Hanumajjayanti</b> Dasami – 17:37 Uttarabhadrā – 10:17 R.K – 11:35 to 13:20 D.M – 09:08 to 10:04 13:48 to 14:44 V – 23:38 to 25:24+</p>	<p><b>5</b> Ekadasi – 19:49 Revati – 12:58 R.K – 09:50 to 11:35 D.M – 06:21 to 08:12 V – NIL <i>Apara Ekadasi</i></p>
<p><b>6</b> Dwadasi – 22:18 Aswini – 15:58 R.K – 18:35 to 20:20 D.M – 18:28 to 19:24 V – 11:28 to 13:16</p>	<p><b>7</b> Trayodasi – 24:54+ Bharani – 19:06 R.K – 08:05 to 09:50 D.M – 13:48 to 14:44 16:36 to 17:32 V – 02:49 to 04:38 <i>Pradosha Vratam</i></p>	<p><b>8</b> Chaturdasi – 27:27+ Krittika – 22:14 R.K – 16:51 to 18:36 D.M – 09:08 to 10:05 24:21+ to 25:01+ V – 08:40 to 10:29</p>	<p><b>9 Sani Jayanti</b> ● Amavasya – 29:52+ Rohini – 25:15+ R.K – 13:21 to 15:06 D.M – 12:53 to 13:49 V – 16:15 to 18:03</p>	<p><b>10 Jyeshtha Masam Begins</b> Pratipada – Full Night Mrigasira – 28:01+ R.K – 15:06 to 16:51 D.M – 11:01 to 11:57 16:37 to 17:33 V – 07:30 to 09:17</p>	<p><b>11</b> Pratipada – 08:00 Arudra – Full Night R.K – 11:36 to 13:21 D.M – 09:09 to 10:05 13:49 to 14:45 V – 13:16 to 15:02</p>	<p><b>12</b> Dwitiya – 09:47 Arudra – 06:28 R.K – 09:51 to 11:36 D.M – 06:20 to 08:13 V – 19:29 to 21:13</p>
<p><b>13</b> Tritiya – 11:10 Punarvasu – 08:31 R.K – 18:38 to 20:23 D.M – 18:31 to 19:27 V – 17:03 to 18:45</p>	<p><b>14 Mithuna Sankramanam</b> Chaturthi – 12:04 Pushyami – 10:07 R.K – 08:06 to 09:51 D.M – 13:50 to 14:46 16:38 to 17:35 V – 23:30 to 25:10+</p>	<p><b>15</b> Panchami – 12:26 Aslesha – 11:12 R.K – 16:53 to 18:38 D.M – 09:09 to 10:05 24:22+ to 25:02+ V – 23:29 to 25:07+</p>	<p><b>16</b> Shashthi – 12:15 Makha – 11:45 R.K – 13:22 to 15:08 D.M – 12:54 to 13:50 V – 19:45 to 21:20</p>	<p><b>17</b> Saptami – 11:29 Poorva Phalguni-11:43 R.K – 15:08 to 16:53 D.M – 11:02 to 11:58 16:39 to 17:35 V – 18:45 to 20:18</p>	<p><b>18</b> Ashtami – 10:09 Uttara Phalguni-11:08 R.K – 11:37 to 13:23 D.M – 09:10 to 10:06 13:51 to 14:47 V – 19:07 to 20:39</p>	<p><b>19</b> Navami – 08:15 Dasami – 29:51+ Hasta – 09:59 R.K – 09:52 to 11:37 D.M – 06:21 to 08:14 V – 17:26 to 18:55</p>
<p><b>20</b> Ekadasi – 27:01+ Chitra – 08:20 Swati – 30:16+ R.K – 18:39 to 20:25 D.M – 18:32 to 19:29 V – 13:27 to 14:54 <i>Nirjala Ekadasi</i></p>	<p><b>21</b> Dwadasi – 23:52 Visakha – 27:53+ R.K – 08:07 to 09:52 D.M – 13:51 to 14:48 16:40 to 17:36 V – 11:18 to 12:45</p>	<p><b>22</b> Trayodasi – 20:29 Anuradha – 25:18+ R.K – 16:54 to 18:40 D.M – 09:10 to 10:07 24:24+ to 25:04+ V – 07:27 to 08:53 <i>Pradosha Vratam</i></p>	<p><b>23</b> Chaturdasi – 17:02 Jyeshtha – 22:41 R.K – 13:24 to 15:09 D.M – 12:56 to 13:52 V – 06:17 to 07:43</p>	<p><b>24 Devasnana Purnima</b> ○ Poornima – 13:39 Moola – 20:10 R.K – 15:09 to 16:55 D.M – 11:03 to 12:00 16:41 to 17:37 V – 18:44 to 20:10</p>	<p><b>25</b> Pratipada – 10:29 Poorvashadha – 17:56 R.K – 11:39 to 13:24 D.M – 09:11 to 10:07 13:52 to 14:48 V – 04:52 to 06:19</p>	<p><b>26</b> Dwitiya – 07:41 Tritiya – 29:24+ Uttarashadha – 16:06 R.K – 09:54 to 11:39 D.M – 06:23 to 08:15 V – 01:19 to 02:48 19:54 to 21:25</p>
<p><b>27</b> Chaturthi – 27:46+ Sraavanam – 14:52 R.K – 18:41 to 20:26 D.M – 18:34 to 19:30 V – 18:46 to 20:20 <i>Sankatahara Chaturthi</i></p>	<p><b>28</b> Panchami – 26:52+ Dhanishtha – 14:19 R.K – 08:09 to 09:54 D.M – 13:53 to 14:49 16:41 to 17:37 V – 21:35 to 23:12</p>	<p><b>29</b> Shashthi – 26:48+ Satabhisha – 14:32 R.K – 16:55 to 18:41 D.M – 09:12 to 10:08 24:25+ to 25:05+ V – 21:12 to 22:52</p>	<p><b>30</b> Saptami – 27:31+ Poorvabhadrā-15:33 R.K – 13:25 to 15:10 D.M – 12:57 to 13:53 V – 25:52+ to 27:35+</p>	<p><b>SRI RAMA JAYA NIKETAN</b> [A Non Profit Organization Fed ID # 47-2362735] <b>THE HINDHU TEMPLE &amp; COMMUNITY CENTRE</b> 5500 Queenston Blvd, Houston, Tx 77084. TOGETHER WE BUILD A BETTER FUTURE <i>Your support is critical to create a world-class temple</i> PLEASE MAKE A PLEDGE</p>		



SUN MON TUE WED THU FRI SAT

**SRI RAMA JAYA NIKETAN**  
(A Non Profit Organization Fed ID # 47-2362735)  
**THE HINDHU TEMPLE & COMMUNITY CENTRE**  
5500 Queenston Blvd, Houston, Tx 77084.  
**TOGETHER WE BUILD A BETTER FUTURE**  
*Your support is critical to create a world-class temple*  
**PLEASE MAKE A PLEDGE**

**NOTE**  
R.K-RAHU KALAM  
D.M-DUR MUHURTHAM  
V-VARJYAM

**1**  
Ashtami - 28:58+  
Uttharabhadra - 17:19  
R.K - 15:11 to 16:56  
D.M - 11:05 to 12:01  
16:42 to 17:38  
V - 01:52 to 02:35

**2**  
Navami - Full Night  
Revati - 19:44  
R.K - 11:40 to 13:26  
D.M - 09:13 to 10:09  
13:54 to 14:50  
V - 06:32 to 08:17

**3**  
Navami - 07:00  
Aswini - 22:36  
R.K - 09:56 to 11:41  
D.M - 06:25 to 08:18  
V - 18:07 to 19:55

**4**  
Dasami - 09:25  
Bharani - 25:42+  
R.K 18:41 - 20:26  
D.M - 18:34 to 19:30  
V - 09:26 to 11:15

**5**  
Ekadasi - 12:00  
Krittika - 28:51+  
R.K - 08:11 to 09:56  
D.M - 13:54 to 14:50  
16:42 to 17:38  
V - 15:16 to 17:05  
**Yogini Ekadasi**

**6**  
Dwadasi - 14:32  
Rohini - Full Night  
R.K - 16:56 to 18:41  
D.M - 09:15 to 10:10  
24:26+ to 25:06+  
V - 22:50 to 24:38+  
**Pradosha Vratam**

**7**  
Thrayodasi - 16:50  
Rohini - 07:49  
R.K - 13:26 to 15:11  
D.M - 12:58 to 13:54  
V - 14:02 to 15:49

**8**  
Chaturdasi - 18:46  
Mrigasira - 10:29  
R.K - 15:11 to 16:56  
D.M - 11:07 to 12:03  
16:42 to 17:38  
V - 19:40 to 21:25

**9** ●  
Amavasya - 20:16  
Arudra - 12:44  
R.K - 11:42 to 13:27  
D.M - 09:16 to 10:11  
13:55 to 14:50  
V - 25:38+ to 27:21+

**10** Ashadha Masam Begins  
Pratipada - 21:17  
Punarvasu - 14:32  
R.K - 09:58 to 11:42  
D.M - 06:29 to 08:20  
V - 22:59 to 24:40+

**11** Jagannath Ratha Yatra  
Dwitiya - 21:49  
Pushyami - 15:52  
R.K - 18:40 to 20:25  
D.M - 18:33 to 19:29  
V - 29:08+ to 06:48

**12**  
Tritiya - 21:54  
Aslesha - 16:45  
R.K - 08:14 to 09:58  
D.M - 13:55 to 14:50  
16:42 to 17:37  
V - 05:08 to 06:48

**13**  
Chaturthi - 21:32  
Makha - 17:11  
R.K - 16:56 to 18:40  
D.M - 09:17 to 10:13  
24:27+ to 25:07+  
V - 04:58 to 06:36  
25:12+ to 26:48+

**14**  
Panchami - 20:46  
Poorva Phalguni-17:13  
R.K - 13:27 to 15:11  
D.M - 12:59 to 13:55  
V - 24:18+ to 25:53+

**15**  
Shashthi - 19:36  
Uttara Phalguni - 16:51  
R.K - 15:11 to 16:55  
D.M - 11:09 to 12:04  
16:42 to 17:37  
V - 25:00+ to 26:33+

**16** Karkataka Sankramanam Dakshinayanam Begins  
Saptami - 18:04  
Hasta - 16:07  
R.K - 11:44 to 13:27  
D.M - 09:18 to 10:13  
13:55 to 14:51  
V - 23:46 to 25:17+

**17**  
Ashtami - 16:11  
Chitra - 15:03  
R.K - 10:00 to 11:44  
D.M - 06:32 to 08:23  
V - 20:19 to 21:49

**18**  
Navami - 13:58  
Swati - 13:38  
R.K - 18:39 to 20:22  
D.M - 18:32 to 19:27  
V - 18:51 to 20:20

**19**  
Dasami - 11:29  
Visakha - 11:57  
R.K - 08:17 to 10:01  
D.M - 13:55 to 14:50  
16:41 to 17:36  
V - 15:38 to 17:07

**20**  
Ekadasi - 08:47  
Dwadasi - 29:56+  
Anuradha - 10:03  
R.K - 16:55 to 18:38  
D.M - 09:20 to 10:15  
24:27+ to 25:08+  
V - 15:10 to 16:38  
**Deva Sayana Ekadasi**

**21**  
Trayodasi - 27:02+  
Jyeshtha - 08:00  
Moola - 29:55+  
R.K - 13:28 to 15:11  
D.M - 13:00 to 13:55  
V - 15:18 to 16:46  
28:28+ to 29:55+  
**Pradosha Vratam**

**22**  
Chathurdasi - 24:13+  
Poorvashadha - 27:56+  
R.K - 15:11 to 16:54  
D.M - 11:10 to 12:05  
16:40 to 17:35  
V - 14:43 to 16:11

**23** Guru Poornima ○  
Poornima - 21:36  
Uttharashadha - 26:10+  
R.K - 11:45 to 13:28  
D.M - 09:21 to 10:16  
13:55 to 14:50  
V - 11:21 to 12:50

**24**  
Pratipada - 19:20  
Sraavanam - 24:48+  
R.K - 10:02 to 11:45  
D.M - 06:36 to 08:26  
V - 05:57 to 07:27

**25**  
Dwitiya - 17:33  
Danishtha - 23:56  
R.K - 18:36 to 20:19  
D.M - 18:29 to 19:24  
V - 04:39 to 30:12

**26**  
Tritiya - 16:24  
Satabhisha - 23:44  
R.K - 08:20 to 10:03  
D.M - 13:55 to 14:50  
16:39 to 17:34  
V - 07:05 to 08:40  
**Sankatahara Chaturthi**

**27**  
Chaturthi - 15:58  
Poorvabhadra - 24:15+  
R.K - 16:53 to 18:35  
D.M - 09:22 to 10:17  
24:26+ to 25:07+  
V - 06:16 to 07:54

**28**  
Panchami - 16:18  
Uttarabhadra - 25:32+  
R.K - 13:28 to 15:10  
D.M - 13:01 to 13:55  
V - 10:22 to 12:03

**29**  
Shashthi - 17:24  
Revati - 27:33+  
R.K - 15:10 to 16:52  
D.M - 11:12 to 12:06  
16:38 to 17:33  
V - 14:33 to 16:17

**30**  
Saptami - 19:10  
Aswini - 30:08+  
R.K - 11:46 to 13:28  
D.M - 09:23 to 10:17  
13:55 to 14:49  
V - 25:42+ to 27:28+

**31**  
Ashtami - 21:26  
Bharani - Full Night  
R.K - 10:04 to 11:46  
D.M - 06:41 to 08:29  
V - 16:55 to 18:43



SUN MON TUE WED THU FRI SAT

<p><b>1</b></p> <p>Navami – 23:57 Bharani – 09:06 R.K – 18:32 to 20:14 D.M – 18:26 to 19:20 V – 22:40 to 24:28+</p>	<p><b>2</b> <i>Aadi Perukku</i></p> <p>Dasami – 26:29+ Krittika – 12:14 R.K – 08:23 to 10:05 D.M – 13:55 to 14:49 16:37 to 17:31 V – 30:14+ to 08:02</p>	<p><b>3</b></p> <p>Ekadasi – 28:47+ Rohini – 15:14 R.K – 16:50 to 18:31 D.M – 09:24 to 10:18 24:25+ to 25:07+ V – 06:14 to 08:02 21:28 to 23:14 <i>Kamika Ekadasi</i></p>	<p><b>4</b></p> <p>Dwadasi – 30:39+ Mrigasira – 17:55 R.K – 13:27 to 15:08 D.M – 13:00 to 13:54 V – 27:06+ to 28:50+</p>	<p><b>5</b></p> <p>Trayodasi – Full Night Arudra – 20:08 R.K – 15:08 to 16:49 D.M – 11:13 to 12:07 16:36 to 17:29 V – 03:06 to 04:50 <i>Pradosha Vratam</i></p>	<p><b>6</b></p> <p>Trayodasi – 07:58 Punarvasu – 21:46 R.K – 11:46 to 13:27 D.M – 09:25 to 10:19 13:54 to 14:48 V – 08:57 to 10:39</p>	<p><b>7</b></p> <p>Chaturdasi – 08:41 Pushyami – 22:49 R.K – 10:06 to 11:46 D.M – 06:45 to 08:32 V – 06:07 to 07:47</p>
<p><b>8</b></p> <p>Amavasya – 08:49 Aslesha – 23:20 R.K – 18:28 to 20:08 D.M – 18:21 to 19:15 V – 11:54 to 13:32</p>	<p><b>9</b> <i>Sravana Masam Begins</i></p> <p>Pratipada – 08:26 Makha – 23:23 R.K – 08:26 to 10:06 D.M – 13:53 to 14:47 16:34 to 17:27 V – 11:22 to 12:58</p>	<p><b>10</b> <i>Hariyali Theej Andal Jayanti</i></p> <p>Dwitiya – 07:35 Tritiya – 30:23+ Poorva Phalguni – 23:02 R.K – 16:47 to 18:27 D.M – 09:27 to 10:20 24:23+ to 25:06+ V – 07:16 to 08:50</p>	<p><b>11</b></p> <p>Chaturthi – 28:54+ Uttara Phalguni – 22:23 R.K – 13:26 to 15:06 D.M – 13:00 to 13:53 V – 06:02 to 07:36</p>	<p><b>12</b> <i>Naga Panchami Garuda Panchami</i></p> <p>Panchami – 27:12+ Hasta – 21:30 R.K – 15:06 to 16:46 D.M – 11:13 to 12:07 16:32 to 17:25 V – 06:28 to 08:01</p>	<p><b>13</b></p> <p>Shashthi – 25:20+ Chitra – 20:26 R.K – 11:47 to 13:26 D.M – 09:27 to 10:20 13:53 to 14:46 V – 05:08 to 06:40 25:45+ to 27:17+</p>	<p><b>14</b></p> <p>Saptami – 23:21 Swati – 19:14 R.K – 10:07 to 11:47 D.M – 06:49 to 08:35 V – 24:32+ to 26:03+</p>
<p><b>15</b></p> <p>Ashtami – 21:15 Visakha – 17:56 R.K – 18:23 to 20:02 D.M – 18:16 to 19:09 V – 21:42 to 23:12</p>	<p><b>16</b> <i>Simha Sankramanam</i></p> <p>Navami – 19:04 Anuradha – 16:32 R.K – 08:29 to 10:08 D.M – 13:52 to 14:45 16:30 to 17:23 V – 21:48 to 23:18</p>	<p><b>17</b></p> <p>Dasami – 16:50 Jyeshtha – 15:05 R.K – 16:43 to 18:21 D.M – 09:28 to 10:21 24:20+ to 25:04+ V – 22:36 to 24:06+</p>	<p><b>18</b></p> <p>Ekadasi – 14:35 Moola – 13:37 R.K – 13:25 to 15:04 D.M – 12:59 to 13:51 V – 12:07 to 13:37 22:39 to 24:10+ <i>Sravana Putrada Ekadasi</i></p>	<p><b>19</b></p> <p>Dwadasi – 12:24 Poorvashadha – 12:12 R.K – 15:03 to 16:41 D.M – 11:14 to 12:06 16:28 to 17:21 V – 19:46 to 21:17 <i>Pradosha Vratam</i></p>	<p><b>20</b> <i>Sri Varal Lakshmi Vratam</i></p> <p>Trayodasi – 10:20 Uttarashadha – 10:55 R.K – 11:47 to 13:25 D.M – 09:29 to 10:22 13:51 to 14:43 V – 14:44 to 16:16</p>	<p><b>21</b> <i>Raksha Bandhan Sravana Poornima Aavani Avittam Sri Gayatri Jayanti Sri Vikhanasacharya Jayanti Onam</i></p> <p>Chaturdasi – 08:30 Sranam – 09:52 R.K – 10:09 to 11:46 D.M – 06:53 to 08:37 V – 13:45 to 15:18</p>
<p><b>22</b></p> <p>Poornima – 07:01 Pratipada – 30:00+ Dhanishtha – 09:10 R.K – 18:17 to 19:55 D.M – 18:11 to 19:03 V – 16:18 to 17:53</p>	<p><b>23</b></p> <p>Dwitiya – 29:34+ Satabhisha – 08:56 R.K – 08:31 to 10:09 D.M – 13:50 to 14:42 16:26 to 17:18 V – 15:26 to 17:03</p>	<p><b>24</b></p> <p>Tritiya – 29:48+ Poorvabhadra – 09:18 R.K – 16:38 to 18:15 D.M – 09:30 to 10:22 24:18+ to 25:02+ V – 19:18 to 20:58</p>	<p><b>25</b></p> <p>Chaturthi – 30:43+ Uttarabhadra – 10:18 R.K – 13:23 to 15:00 D.M – 12:57 to 13:49 V – 23:09 to 24:51+ <i>Sankatahara Chaturthi</i></p>	<p><b>26</b></p> <p>Panchami – Full Night Revati – 11:59 R.K – 15:00 to 16:37 D.M – 11:14 to 12:06 16:24 to 17:15 V – NIL</p>	<p><b>27</b></p> <p>Panchami – 08:18 Ashwini – 14:18 R.K – 11:46 to 13:23 D.M – 09:31 to 10:22 13:48 to 14:40 V – 09:55 to 11:40 25:01+ to 26:48+</p>	<p><b>28</b></p> <p>Shashthi – 10:26 Bharani – 17:05 R.K – 10:10 to 11:46 D.M – 06:57 to 08:40 V – 30:37+ to 08:25</p>
<p><b>29</b></p> <p>Saptami – 12:55 Krittika – 20:09 R.K – 18:11 to 19:47 D.M – 18:04 to 18:56 V – 06:37 to 08:25</p>	<p><b>30</b> <i>Sri Krishna Janmashtami</i></p> <p>Ashtami – 15:29 Rohini – 23:14 R.K – 08:34 to 10:10 D.M – 13:47 to 14:39 16:21 to 17:12 V – 14:12 to 16:01</p>	<p><b>31</b></p> <p>Navami – 17:53 Mrigasira – 26:05+ R.K – 16:33 to 18:09 D.M – 09:32 to 10:23 24:14+ to 24:59+ V – 05:30 to 07:17</p>	<p><b>SRI RAMA JAYA NIKETAN</b> [A Non Profit Organization Fed ID # 47-2362735] <b>THE HINDHU TEMPLE &amp; COMMUNITY CENTRE</b> 5500 Queenston Blvd, Houston, Tx 77084. <b>TOGETHER WE BUILD A BETTER FUTURE</b> <i>Your support is critical to create a world-class temple</i> <b>PLEASE MAKE A PLEDGE</b></p>			<p><b>NOTE</b> R.K – RAHU KALAM D.M – DUR MUHURTHAM V – VARJYAM</p>



SUN

MON

TUE

WED

THU

FRI

SAT

**SRI RAMA JAYA NIKETAN**  
(A Non Profit Organization Fed ID # 47-2362735)  
**THE HINDHU TEMPLE & COMMUNITY CENTRE**  
5500 Queenston Blvd, Houston, Tx 77084.  
**TOGETHER WE BUILD A BETTER FUTURE**  
*Your support is critical to create a world-class temple*  
**PLEASE MAKE A PLEDGE**

**1**  
Dasami – 19:51  
Arudra – 28:27+  
R.K – 13:21 to 14:57  
D.M – 12:56 to 13:47  
V – 11:19 to 13:04

**2**  
Ekadasi – 21:14  
Punarvasu – 30:12+  
R.K – 14:56 to 16:32  
D.M – 11:14 to 12:05  
16:19 to 17:10  
V – 17:20 to 19:03  
**Aja Ekadasi**

**3**  
Dwadasi – 21:54  
Pushyami – Full Night  
R.K – 11:45 to 13:21  
D.M – 09:32 to 10:23  
13:46 to 14:37  
V – 14:33 to 16:13

**4** *Sani Trayodasi*  
Trayodasi – 21:51  
Pushyami – 07:15  
R.K – 10:10 to 11:45  
D.M – 07:01 to 08:42  
V – 20:15 to 21:52  
**Pradosha Vratam**

**5**  
Chaturdasi – 21:08  
Aslesha – 07:37  
R.K – 18:04 to 19:39  
D.M – 17:58 to 18:48  
V – 19:29 to 21:04

**6**  
Amavasya – 19:51  
Makha – 07:22  
Poorva Phalguni – 30:35+  
R.K – 08:36 to 10:11  
D.M – 13:45 to 14:35  
16:16 to 17:06  
V – 15:06 to 16:39

**7** *Bhadrapada Masam Begins*  
Pratipada – 18:07  
Uttara Phalguni – 29:26+  
R.K – 16:28 to 18:02  
D.M – 09:33 to 10:23  
24:11+ to 24:57+  
V – 13:26 to 14:58

**8**  
Dwitiya – 16:03  
Hasta – 28:01+  
R.K – 13:19 to 14:53  
D.M – 12:54 to 13:44  
V – 13:20 to 14:50

**9** *Sri Vinayaka Chavithi Harthaliika Teej*  
Tritiya – 13:48  
Chitra – 26:28+  
R.K – 14:52 to 16:26  
D.M – 11:13 to 12:03  
16:14 to 17:04  
V – 11:30 to 13:00

**10** *Rishi Panchami*  
Chaturthi – 11:27  
Swati – 24:53+  
R.K – 11:45 to 13:18  
D.M – 09:33 to 10:23  
13:43 to 14:33  
V – 07:42 to 09:11

**11**  
Panchami – 09:07  
Shashti – 30:50+  
Visakha – 23:20  
R.K – 10:11 to 11:44  
D.M – 07:04 to 08:44  
V – 06:07 to 07:37

**12**  
Saptami – 28:40+  
Anuradha – 21:54  
R.K – 17:57 to 19:30  
D.M – 17:51 to 18:40  
V – 03:06 to 04:36

**13** *Radha Ashtami*  
Ashtami – 26:39+  
Jyeshtha – 20:35  
R.K – 08:38 to 10:11  
D.M – 13:42 to 14:31  
16:11 to 17:00  
V – 03:11 to 04:42

**14**  
Navami – 24:47+  
Moola – 19:25  
R.K – 16:22 to 17:55  
D.M – 09:34 to 10:24  
24:07+ to 24:54+  
V – 04:12 to 05:43  
17:54 to 19:25

**15**  
Dasami – 23:06  
Poorvashadha – 18:26  
R.K – 13:16 to 14:49  
D.M – 12:52 to 13:41  
V – 04:38 to 06:10  
26:10+ to 27:43+

**16** *Kanya Sankramanam Purattasi*  
Ekadasi – 21:37  
Uttarashadha – 17:39  
R.K – 14:48 to 16:21  
D.M – 11:13 to 12:02  
16:08 to 16:57  
V – 21:33 to 23:07  
**Parsva Ekadasi**

**17**  
Dwadasi – 20:24  
Sraavanam – 17:06  
R.K – 11:44 to 13:16  
D.M – 09:35 to 10:24  
13:40 to 14:29  
V – 21:04 to 22:39

**18** *Sani Trayodasi*  
Trayodasi – 19:29  
Dhanishtha – 16:51  
R.K – 10:12 to 11:43  
D.M – 07:08 to 08:46  
V – 24:05+ to 25:42+  
**Pradosha Vratam**

**19** *Sri Anantha Padmanabha Chaturdasi*  
Chaturdasi – 18:58  
Satabhisha – 16:58  
R.K – 17:50 to 19:21  
D.M – 17:44 to 18:33  
V – 23:31 to 25:10+

**20**  
Poornima – 18:54  
Poorvabhadra – 17:32  
R.K – 08:40 to 10:12  
D.M – 13:39 to 14:28  
16:05 to 16:54  
V – 27:34+ to 29:14+

**21** *Mahalaya Paksham Begins*  
Pratipada – 19:21  
Uttarabhadra – 18:37  
R.K – 16:17 to 17:48  
D.M – 09:35 to 10:24  
24:03+ to 24:51+  
V – 04:34 to 05:14

**22**  
Dwitiya – 20:23  
Revati – 20:14  
R.K – 13:14 to 14:45  
D.M – 12:50 to 13:38  
V – 07:25 to 09:08

**23**  
Tritiya – 21:59  
Aswini – 22:24  
R.K – 14:44 to 16:15  
D.M – 11:13 to 12:01  
16:03 to 16:51  
V – 18:03 to 19:47

**24**  
Chaturthi – 24:06+  
Bharani – 25:03+  
R.K – 11:43 to 13:13  
D.M – 09:36 to 10:24  
13:37 to 14:26  
V – 09:04 to 10:50  
**Sankatahara Chaturthi**

**25**  
Panchami – 26:34+  
Krittika – 28:03+  
R.K – 10:12 to 11:43  
D.M – 07:12 to 08:48  
V – 14:33 to 16:21

**26**  
Shashti – 29:13+  
Rohini – 31:12+  
R.K – 17:43 to 19:13  
D.M – 17:37 to 18:25  
V – 22:09 to 23:58

**27**  
Saptami – Full Night  
Mrigasira – Full Night  
R.K – 08:43 to 10:12  
D.M – 13:36 to 14:24  
16:00 to 16:48  
V – 13:30 to 15:19

**28**  
Saptami – 07:46  
Mrigasira – 10:14  
R.K – 16:11 to 17:41  
D.M – 09:37 to 10:25  
24:00 to 24:48+  
V – 19:35 to 21:22

**29**  
Ashtami – 09:59  
Arudra – 12:56  
R.K – 13:11 to 14:41  
D.M – 12:48 to 13:35  
V – 26:00+ to 27:44+

**30**  
Navami – 11:38  
Punarvasu – 15:03  
R.K – 14:40 to 16:10  
D.M – 11:12 to 12:00  
15:58 to 16:45  
V – 23:31 to 25:13+

NOTE  
R.K-RAHU KALAM  
D.M-DUR MUHURTHAM  
V-VARJYAM

Ph:281-750-9199  
info@sriramajaya.org  
www.sriramajaya.org



SUN	MON	TUE	WED	THU	FRI	SAT
<p><b>31</b> Ekadasi – 26:51+ Poorva Phalguni–26:23+ R.K – 17:13 to 18:35 D.M – 17:07 to 17:51 V – 10:39 to 12:13 <i>Rama Ekadasi</i></p>	<p><b>SRI RAMA JAYA NIKETAN</b> [A Non Profit Organization Fed ID # 47-2362735] <b>THE HINDHU TEMPLE &amp; COMMUNITY CENTRE</b> 5500 Queenston Blvd, Houston, Tx 77084. <b>TOGETHER WE BUILD A BETTER FUTURE</b> <i>Your support is critical to create a world-class temple</i> <b>PLEASE MAKE A PLEDGE</b></p>			<p><b>NOTE</b> R.K–RAHU KALAM D.M–DUR MUHURTHAM V–VARJYAM</p>	<p><b>1</b> Dasami – 12:33 Pushya – 16:28 R.K – 11:42 to 13:11 D.M – 09:37 to 10:25 13:35 to 14:22 V – 29:36+ to 31:14+</p>	<p><b>2</b> Ekadasi – 12:40 Aslesha – 17:05 R.K – 10:13 to 11:42 D.M – 07:16 to 08:03 08:03 to 08:50 V – 05:01, Oct 03 to 06:36, Oct 03 <i>Indira Ekadasi</i></p>
<p><b>3</b> Dwadasi – 11:59 Makha – 16:56 R.K – 17:36 to 19:04 D.M – 17:30 to 18:17 V – 24:39+ to 26:12+ <i>Pradosha Vratam</i></p>	<p><b>4</b> Trayodasi – 10:35 Poorva Phalguni–16:06 R.K – 08:45 to 10:13 D.M – 13:33 to 14:21 15:55 to 16:42 V – 22:52 to 24:22+</p>	<p><b>5</b> <i>Mahalaya Paksham Ends</i> Chathurdasi – 08:34 Amavasya – 30:04+ Uttara Phalguni – 14:40 R.K – 16:06 to 17:34 D.M – 09:38 to 10:25 23:56 to 24:45+ V – 22:26 to 23:54</p>	<p><b>6</b> <i>Navratri Begins Aswayuja Masam Begins</i> Pratipada – 27:16+ Hasta – 12:50 R.K – 13:09 to 14:37 D.M – 12:46 to 13:33 V – 20:07 to 21:35</p>	<p><b>7</b> Dwitiya – 24:18+ Chithra – 10:43 R.K – 14:37 to 16:04 D.M – 11:12 to 11:59 15:53 to 16:39 V – 15:48 to 17:15</p>	<p><b>8</b> Tritiya – 21:18 Swati – 08:29 Vishakha – 30:17+ R.K – 11:41 to 13:09 D.M – 09:39 to 10:26 13:32 to 14:19 V – 13:34 to 15:02</p>	<p><b>9</b> Chaturthi – 18:25 Anuradha – 28:14+ R.K – 10:14 to 11:41 D.M – 07:20 to 08:06 08:06 to 08:53 V – 09:57 to 11:24</p>
<p><b>10</b> Panchami – 15:44 Jyeshtha – 26:26+ R.K – 17:29 to 18:56 D.M – 17:23 to 18:10 V – 09:25 to 10:54</p>	<p><b>11</b> <i>Saraswati Pooja</i> Shashti – 13:20 Moola – 24:57+ R.K – 08:48 to 10:14 D.M – 11:31 to 14:17 15:50 to 16:36 V – 09:56 to 11:26 23:26 to 24:57+</p>	<p><b>12</b> Saptami – 11:17 Poorvashadha – 23:49 R.K – 116:01 to 17:27 D.M – 09:40 to 10:26 23:53 to 24:43+ V – 10:06 to 11:37</p>	<p><b>13</b> <i>Durga Ashtami Mahar Navami</i> Ashtami – 09:37 Uttharashadha – 23:06 R.K – 13:07 to 14:34 D.M – 12:44 to 13:30 V – 07:35 to 09:08 27:02+ to 28:37+</p>	<p><b>14</b> <i>Vijaya Dasami Dasara</i> Navami – 08:22 Sraavanam – 22:46 R.K – 14:33 to 15:59 D.M – 11:12 to 11:58 15:48 to 16:34 V – 26:47+ to 28:24+</p>	<p><b>15</b> Dashami – 07:32 Ekadasi – 31:07+ Dhanishta – 22:52 R.K – 11:41 to 13:07 D.M – 09:41 to 10:27 13:30 to 14:16 V–30:13+ to 07:51 on Oct 16 <i>Papankusa Ekadasi</i></p>	<p><b>16</b> Dwadasi – 31:09+ Satabhisha – 23:23 R.K – 10:15 to 11:41 D.M – 07:24 to 08:55 V – 30:02+ to 07:42 on Oct 17</p>
<p><b>17</b> <i>Thula Sankramanam</i> Thrayodasi – Full Night Poorvabhadra – 24:20+ R.K – 17:23 to 18:48 D.M – 17:17 to 18:03 V – NIL <i>Pradosha Vratam</i></p>	<p><b>18</b> Thrayodasi – 07:37 Uttarabhadra–25:43+ R.K – 08:51 to 10:16 D.M – 13:29 to 14:15 15:45 to 16:31 V – 10:29 to 12:10</p>	<p><b>19</b> Chaturdasi – 08:33 Revati – 27:32+ R.K – 15:56 to 17:21 D.M – 09:42 to 10:27 23:50 to 24:41+ V – 14:37 to 16:21</p>	<p><b>20</b> Poornima – 09:56 Aswini – 29:47+ R.K – 13:06 to 14:31 D.M – 12:43 to 13:29 V – 25:25+ to 27:10+</p>	<p><b>21</b> Pratipada – 11:45 Bharani – Full Night R.K – 14:30 to 15:55 D.M – 11:13 to 11:58 15:44 to 16:29 V – 16:27 to 18:13</p>	<p><b>22</b> Dwitiya – Full Night Bharani – 08:26 R.K – 11:41 to 13:06 D.M – 09:43 to 10:28 13:28 to 14:13 V – 21:55 to 23:43</p>	<p><b>23</b> <i>Atla Tadde Karva Chowth</i> Tritiya – 16:31 Krittika – 11:23 R.K – 10:17 to 11:41 D.M – 07:29 to 08:59 V – 29:29+ to 31:18+ <i>Sankatahara Chaturthi</i></p>
<p><b>24</b> Chaturthi – 19:13 Rohini – 14:32 R.K – 17:17 to 18:41 D.M – 17:12 to 17:57 V – 20:52 to 22:41</p>	<p><b>25</b> Panchami – 21:53 Mrigasira – 17:41 R.K – 08:54 to 10:18 D.M – 13:28 to 14:12 15:42 to 16:26 V – 27:07+ to 28:55+</p>	<p><b>26</b> Shashti – 24:20+ Arudra – 20:38 R.K – 15:52 to 17:16 D.M – 09:45 to 10:29 23:48 to 24:40+ V – NIL</p>	<p><b>27</b> Saptami – 26:19+ Punarvasu – 23:11 R.K – 13:05 to 14:28 D.M – 12:43 to 13:27 V – 09:55 to 11:41</p>	<p><b>28</b> Ashtami – 27:39+ Pushyami – 25:09+ R.K – 14:28 to 15:51 D.M – 11:14 to 11:58 15:40 to 16:25 V – 07:51 to 09:34</p>	<p><b>29</b> Navami – 28:13+ Aslesha – 26:22+ R.K – 11:42 to 13:05 D.M – 09:46 to 10:30 13:27 to 14:11 V – 14:36 to 16:17</p>	<p><b>30</b> Dasami – 27:57+ Makha – 26:47+ R.K – 10:19 to 11:42 D.M – 07:34 to 09:02 V – 14:34 to 16:12</p>



SUN	MON	TUE	WED	THU	FRI	SAT
<p><b>NOTE</b> R.K-RAHU KALAM D.M-DUR MUHURTHAM V-VARJYAM</p>	<p><b>1</b> Dwadasi – 25:01+ Uttara Phalguni – 25:14+ R.K – 08:58 to 10:20 D.M – 13:27 to 14:11 15:39 to 16:23 V – 09:14 to 10:46</p>	<p><b>2</b> Dhana Trayodasi Trayodasi – 22:32 Hasta – 23:28 R.K – 15:49 to 17:11 D.M – 09:48 to 10:31 23:47 to 24:39+ V – 09:01 to 10:30 <b>Pradosha Vratam</b></p>	<p><b>3</b> Naraka Chaturdasi Lakshmi Pooja Chaturdasi – 19:33 Chitra – 21:13 R.K – 13:05 to 14:27 D.M – 12:43 to 13:27 V – 06:43 to 08:10</p>	<p><b>4</b> Deepavali Amavasya – 16:14 Swati – 18:38 R.K – 14:27 to 15:48 D.M – 11:16 to 11:59 15:38 to 16:21 V – 02:13 to 03:39 23:35 to 25:00+</p>	<p><b>5</b> Kartika Masam Begins Bhaiya Dooj Bhagini Hastha Bhojanam Pratipada – 12:44 Visakha – 15:53 R.K – 11:43 to 13:05 D.M – 09:49 to 10:32 13:27 to 14:10 V – 19:26 to 20:51</p>	<p><b>6</b> Dwitiya – 09:14 Tritiya – 28:51+ Anuradha – 13:09 R.K – 10:22 to 11:43 D.M – 07:39 to 09:06 V – 18:09 to 19:34</p>
<p><b>7</b> Nagula Chaviti Chaturthi – 25:46+ Jyeshtha – 09:35 R.K – 16:09 to 17:30 D.M – 16:03 to 16:47 V – 16:49 to 18:16</p>	<p><b>8</b> Panchami – 23:05 Moola – 07:19 Poorvashadha – 29:30+ R.K – 08:02 to 09:23 D.M – 12:27 to 13:10 14:36 to 15:20 V – 05:52 to 07:19 16:11 to 17:40</p>	<p><b>9</b> Soora Samharam Chaath Pooja Skanda Shashthi Shashthi – 20:55 Uttarashadha – 28:12+ R.K – 14:47 to 16:08 D.M – 08:51 to 09:34 22:46 to 23:39 V – 13:04 to 14:34</p>	<p><b>10</b> Saptami – 19:19 Srananam – 27:29+ R.K – 12:05 to 13:26 D.M – 11:44 to 12:27 V – 08:05 to 09:38</p>	<p><b>11</b> Ashtami – 18:21 Dhanishtha – 27:24+ R.K – 13:26 to 14:46 D.M – 10:18 to 11:01 14:36 to 15:19 V – 07:28 to 09:04</p>	<p><b>12</b> Navami – 18:01 Satabhisha – 27:55+ R.K – 10:45 to 12:05 D.M – 08:52 to 09:35 12:27 to 13:10 V – 10:45 to 12:23</p>	<p><b>13</b> Dasami – 18:18 Poorvabhada – 29:01+ R.K – 09:25 to 10:45 D.M – 06:45 to 08:10 V – 10:37 to 12:17</p>
<p><b>14</b> Ekadasi – 19:09 Uttarabhada – 30:39+ R.K – 16:06 to 17:26 D.M – 16:01 to 16:43 V – 15:17 to 16:59 <b>Prabhodini Ekadasi</b></p>	<p><b>15</b> Kaisika Dwadasi Tulasi Vivah Dwadasi – 20:31 Revati – Full Night R.K – 08:06 to 09:26 D.M – 12:27 to 13:10 14:35 to 15:18 V – 19:42 to 21:26</p>	<p><b>16</b> Vrischika Sankramanam Trayodasi – 22:20 Revati – 08:45 R.K – 14:46 to 16:05 D.M – 08:55 to 09:37 22:46 to 23:40 V – 30:48 to 32:34 <b>Pradosha Vratam</b></p>	<p><b>17</b> Chaturdasi – 24:30+ Aswini – 11:13 R.K – 12:06 to 13:26 D.M – 11:45 to 12:28 V – 06:48 to 08:34 21:56 to 23:43</p>	<p><b>18</b> Kartika Poornima Poornima – 26:56+ Bharani – 14:00 R.K – 13:26 to 14:45 D.M – 10:21 to 11:03 14:35 to 15:17 V – 27:29+ to 29:17+</p>	<p><b>19</b> Pratipada – 29:34+ Krittika – 16:59 R.K – 10:47 to 12:07 D.M – 08:56 to 09:39 12:28 to 13:10 V – 03:29 to 05:17</p>	<p><b>20</b> Dwitiya – Full Night Rohini – 20:06 R.K – 09:33 to 10:51 D.M – 06:50 to 08:15 V – 11:04 to 12:52</p>
<p><b>21</b> Dwitiya – 08:17 Mrigasira – 23:14 R.K – 16:04 to 17:23 D.M – 15:59 to 16:41 V – 02:26 to 04:15</p>	<p><b>22</b> Tritiya – 10:56 Arudra – 26:14+ R.K – 08:11 to 09:30 D.M – 12:29 to 13:11 14:35 to 15:17 V – 08:41 to 10:29 <b>Sankatahara Chaturthi</b></p>	<p><b>23</b> Chaturthi – 13:25 Punarvasu – 28:59+ R.K – 14:45 to 16:04 D.M – 08:59 to 09:41 22:47 to 23:41 V – 15:37 to 17:24</p>	<p><b>24</b> Panchami – 15:33 Pushyami – Full Night R.K – 12:08 to 13:27 D.M – 11:47 to 12:29 V – 13:46 to 15:32</p>	<p><b>25</b> Shashthi – 17:12 Pushyami – 07:20 R.K – 13:27 to 14:45 D.M – 10:24 to 11:06 14:35 to 15:17 V – 21:05 to 22:48</p>	<p><b>26</b> Saptami – 18:13 Aslesha – 09:07 R.K – 10:50 to 12:09 D.M – 09:01 to 09:42 12:30 to 13:11 V – 21:40 to 23:21</p>	<p><b>27</b> Kalabhairava Jayanti Ashtami – 18:30 Makha – 10:13 R.K – 09:42 to 11:08 D.M – 06:56 to 08:20 V – 18:21 to 19:58</p>
<p><b>28</b> Navami – 18:00 Poorva Phalguni – 10:36 R.K – 16:04 to 17:22 D.M – 15:58 to 16:40 V – 17:41 to 19:15</p>	<p><b>29</b> Dasami – 16:43 Uttara Phalguni – 10:12 R.K – 08:16 to 09:34 D.M – 12:31 to 13:12 14:35 to 15:17 V – 18:12 to 19:44</p>	<p><b>30</b> Ekadasi – 14:43 Hasta – 09:04 R.K – 14:46 to 16:04 D.M – 09:03 to 09:45 22:49 to 23:43 V – 16:29 to 17:57 <b>Utpanna Ekadasi</b></p>	<p><b>SRI RAMA JAYA NIKETAN</b> [A Non Profit Organization Fed ID # 47-2362735] <b>THE HINDHU TEMPLE &amp; COMMUNITY CENTRE</b> 5500 Queenston Blvd, Houston, Tx 77084. <b>TOGETHER WE BUILD A BETTER FUTURE</b> <i>Your support is critical to create a world-class temple</i> <b>PLEASE MAKE A PLEDGE</b></p>			<p>Ph:281-750-9199 info@sriramajaya.org www.sriramajaya.org</p>



SUN

MON

TUE

WED

THU

FRI

SAT

**SRI RAMA JAYA NIKETAN**

(A Non Profit Organization Fed ID # 47-2362735)

**THE HINDHU TEMPLE & COMMUNITY CENTRE**

5500 Queenston Blvd, Houston, Tx 77084.

TOGETHER WE BUILD A BETTER FUTURE

Your support is critical to create a world-class temple

PLEASE MAKE A PLEDGE

**1**  
Dwadasi – 12:05  
Chitra – 07:17  
Swati – 28:58+  
R.K – 12:10 to 13:28  
D.M – 11:50 to 12:31  
V – 12:21 to 13:47  
**Pradosha Vratam**

**2**  
Trayodasi – 08:56  
Chaturdasi – 29:25+  
Visakha – 26:15+  
R.K – 13:29 to 14:46  
D.M – 10:27 to 11:09  
14:36 to 15:17  
V – 09:56 to 11:21

**3** ●  
Amavasya – 25:42+  
Anuradha – 23:18  
R.K – 10:54 to 12:11  
D.M – 09:05 to 09:46  
12:32 to 13:13  
V – 05:45 to 07:09  
28:12+ to 29:36+

**4** *Mrigasira Masam Begins*  
Pratipada – 21:57  
Jyeshtha – 20:17  
R.K – 09:37 to 10:54  
D.M – 07:02 to 08:24  
V – 27:20+ to 28:44+

**5**  
Dwitiya – 18:20  
Moola – 17:24  
R.K – 16:04 to 17:22  
D.M – 15:59 to 16:40  
V – 16:00 to 17:24  
25:58+ to 27:24+

**6**  
Tritiya – 15:01  
Poorvashadha – 14:49  
R.K – 08:21 to 09:38  
D.M – 12:33 to 13:14  
14:37 to 15:18  
V – 22:07 to 23:34

**7**  
Chaturthi – 12:10  
Uttarashadha – 12:42  
R.K – 14:47 to 16:05  
D.M – 09:08 to 09:49  
22:51 to 23:46  
V – 16:26 to 17:56

**8** *Sri Subrahmanya Shashthi*  
Panchami – 09:55  
Sraavanam – 11:10  
R.K – 12:13 to 13:31  
D.M – 11:53 to 12:34  
V – 15:02 to 16:34

**9**  
Shashthi – 08:23  
Dhanishtha – 10:21  
R.K – 13:31 to 14:48  
D.M – 10:31 to 11:12  
14:38 to 15:19  
V – 17:32 to 19:08

**10**  
Saptami – 07:39  
Satabhisha – 10:18  
R.K – 10:57 to 12:14  
D.M – 09:09 to 09:50  
12:35 to 13:16  
V – 16:54 to 18:33

**11**  
Ashtami – 07:42  
Poorvabhadra – 11:02  
R.K – 09:41 to 10:58  
D.M – 07:07 to 08:29  
V – 21:13 to 22:55

**12**  
Navami – 08:32  
Uttarabhadra – 12:30  
R.K – 16:06 to 17:23  
D.M – 16:01 to 16:42  
V – 25:33+ to 27:17+

**13**  
Dasami – 10:02  
Revati – 14:35  
R.K – 08:25 to 09:42  
D.M – 12:36 to 13:17  
14:39 to 15:20  
V – 01:33 to 03:17

**14** *Sri Geeta Jayanti*  
Ekadasi – 12:05  
Aswini – 17:10  
R.K – 14:50 to 16:07  
D.M – 09:12 to 09:53  
22:54 to 23:49  
V – 12:45 to 14:31  
**Mokshada Ekadasi**

**15** *Dhanur Masam Begins*  
Dwadasi – 14:31  
Bharani – 20:05  
R.K – 12:17 to 13:34  
D.M – 11:56 to 12:37  
V – 03:56 to 05:44  
**Pradosha Vratam**

**16**  
Trayodasi – 17:10  
Krittika – 23:11  
R.K – 13:34 to 14:51  
D.M – 10:35 to 11:16  
14:41 to 15:22  
V – 09:38 to 11:26

**17**  
Chaturdasi – 19:54  
Rohini – 26:19+  
R.K – 11:01 to 12:18  
D.M – 09:13 to 09:54  
12:38 to 13:19  
V – 17:16 to 19:05

**18** ○ *Dattatreya Jayanti*  
Poornima – 22:35  
Mrigasira – 29:23+  
R.K – 09:45 to 11:01  
D.M – 07:11 to 08:33  
V – 08:38 to 10:26

**19**  
Pratipada – 25:06+  
Arudra – Full Night  
R.K – 16:09 to 17:26  
D.M – 16:04 to 16:45  
V – 14:47 to 16:35

**20** *Arudra Darsanam*  
Dwitiya – 27:23+  
Arudra – 08:16  
R.K – 08:29 to 09:46  
D.M – 12:40 to 13:21  
14:42 to 15:23  
V – 21:36 to 23:22

**21**  
Tritiya – 29:22+  
Punarvasu – 10:55  
R.K – 14:53 to 16:10  
D.M – 09:15 to 09:56  
22:57 to 23:52  
V – 19:42 to 21:27

**22**  
Chaturthi – 30:57+  
Pushyami – 13:15  
R.K – 12:20 to 13:37  
D.M – 12:00 to 12:41  
V – 27:05+ to 28:49+  
**Sankatahara Chaturthi**

**23**  
Panchami – Full Night  
Aslesha – 15:12  
R.K – 13:37 to 14:54  
D.M – 10:38 to 11:19  
14:44 to 15:25  
V – 27:56+ to 29:38+

**24**  
Panchami – 08:04  
Makha – 16:40  
R.K – 11:04 to 12:21  
D.M – 09:17 to 09:58  
12:42 to 13:23  
V – 24:58+ to 26:38+

**25**  
Shashthi – 08:39  
Poorva Phalguni – 17:36  
R.K – 09:48 to 11:05  
D.M – 07:14 to 08:36  
V – 24:54+ to 26:31+

**26**  
Saptami – 08:38  
Uttara Phalguni – 17:56  
R.K – 16:13 to 17:29  
D.M – 16:07 to 16:48  
V – 26:13+ to 27:48+

**27**  
Ashtami – 07:58  
Navami – 30:39+  
Hasta – 17:38  
R.K – 08:32 to 09:49  
D.M – 12:43 to 13:24  
14:46 to 15:27  
V – 25:19+ to 26:51+

**28**  
Dasami – 28:42+  
Chitra – 16:41  
R.K – 14:57 to 16:14  
D.M – 09:19 to 10:00  
23:01 to 23:56  
V – 21:56 to 23:26

**29**  
Ekadasi – 26:10+  
Swati – 15:09  
R.K – 12:24 to 13:41  
D.M – 12:03 to 12:44  
V – 20:16 to 21:43  
**Saphala Ekadasi**

**30**  
Dwadasi – 23:09  
Visakha – 13:04  
R.K – 13:41 to 14:58  
D.M – 10:41 to 11:23  
14:48 to 15:29  
V – 16:39 to 18:05

**31**  
Trayodasi – 19:47  
Anuradha – 10:34  
R.K – 11:08 to 12:25  
D.M – 09:20 to 10:01  
12:45 to 13:26  
V – 15:32 to 16:56  
**Pradosha Vratam**

**NOTE**  
R.K – RAHU KALAM  
D.M – DUR MUHURTHAM  
V – VARJYAM



## Sun Rise - Sun Set Chart

Date	January	February	March	April	May	June	July	August	September	October	November	December
1	07:17 - 17:34	07:11 - 17:59	06:47 - 18:21	07:11 - 19:40	06:39 - 19:59	06:21 - 20:18	06:25 - 20:26	06:41 - 20:14	06:59 - 19:43	07:15 - 19:07	07:35 - 18:34	06:59 - 17:22
2	07:17 - 17:34	07:10 - 18:00	06:46 - 18:22	07:09 - 19:41	06:38 - 19:59	06:21 - 20:18	06:25 - 20:26	06:42 - 20:13	06:59 - 19:42	07:16 - 19:05	07:36 - 18:34	07:00 - 17:22
3	07:17 - 17:35	07:10 - 18:01	06:45 - 18:22	07:08 - 19:42	06:37 - 20:00	06:21 - 20:19	06:25 - 20:26	06:42 - 20:13	07:00 - 19:41	07:16 - 19:04	07:37 - 18:33	07:01 - 17:22
4	07:17 - 17:36	07:09 - 18:02	06:44 - 18:23	07:07 - 19:42	06:36 - 20:01	06:21 - 20:19	06:26 - 20:26	06:43 - 20:12	07:01 - 19:40	07:17 - 19:03	07:38 - 18:32	07:02 - 17:22
5	07:18 - 17:37	07:09 - 18:03	06:42 - 18:24	07:06 - 19:43	06:35 - 20:01	06:21 - 20:20	06:26 - 20:26	06:44 - 20:11	07:01 - 19:39	07:17 - 19:02	07:38 - 18:31	07:02 - 17:22
6	07:18 - 17:37	07:08 - 18:04	06:41 - 18:24	07:05 - 19:43	06:35 - 20:02	06:20 - 20:20	06:27 - 20:26	06:44 - 20:10	07:02 - 19:37	07:18 - 19:01	07:39 - 18:31	07:03 - 17:22
7	07:18 - 17:37	07:07 - 18:04	06:40 - 18:25	07:04 - 19:44	06:34 - 20:03	06:20 - 20:21	06:27 - 20:25	06:45 - 20:09	07:02 - 19:36	07:19 - 19:00	06:40 - 17:30	07:04 - 17:22
8	07:18 - 17:39	07:06 - 18:05	06:39 - 18:26	07:02 - 19:45	06:33 - 20:03	06:20 - 20:21	06:28 - 20:25	06:45 - 20:08	07:03 - 19:35	07:19 - 18:58	06:41 - 17:29	07:05 - 17:22
9	07:18 - 17:40	07:06 - 18:06	06:38 - 18:26	07:01 - 19:45	06:32 - 20:04	06:20 - 20:21	06:28 - 20:25	06:46 - 20:08	07:03 - 19:34	07:20 - 18:57	06:41 - 17:29	07:05 - 17:22
10	07:18 - 17:40	07:05 - 18:07	06:37 - 18:27	07:00 - 19:46	06:32 - 20:05	06:20 - 20:22	06:29 - 20:25	06:47 - 20:07	07:04 - 19:33	07:20 - 18:56	06:42 - 17:28	07:06 - 17:23
11	07:18 - 17:41	07:04 - 18:08	06:36 - 18:28	06:59 - 19:46	06:31 - 20:05	06:20 - 20:22	06:29 - 20:25	06:47 - 20:06	07:04 - 19:31	07:21 - 18:55	06:43 - 17:28	07:07 - 17:23
12	07:18 - 17:42	07:03 - 18:08	06:34 - 18:28	06:58 - 19:47	06:30 - 20:06	06:20 - 20:23	06:30 - 20:24	06:48 - 20:05	07:05 - 19:30	07:22 - 18:54	06:44 - 17:27	07:07 - 17:23
13	07:18 - 17:43	07:02 - 18:09	06:33 - 18:29	06:57 - 19:48	06:30 - 20:06	06:20 - 20:23	06:30 - 20:24	06:48 - 20:04	07:05 - 19:29	07:22 - 18:53	06:45 - 17:26	07:08 - 17:23
14	07:18 - 17:44	07:02 - 18:10	07:32 - 19:29	06:56 - 19:48	06:29 - 20:07	06:20 - 20:23	06:31 - 20:24	06:49 - 20:03	07:06 - 19:28	07:23 - 18:52	06:45 - 17:26	07:09 - 17:24
15	07:17 - 17:45	07:01 - 18:11	07:31 - 19:30	06:55 - 19:49	06:28 - 20:08	06:21 - 20:24	06:31 - 20:23	06:49 - 20:02	07:06 - 19:26	07:23 - 18:51	06:46 - 17:26	07:09 - 17:24
16	07:17 - 17:46	07:00 - 18:12	07:30 - 19:31	06:53 - 19:49	06:28 - 20:08	06:21 - 20:24	06:32 - 20:23	06:50 - 20:01	07:07 - 19:25	07:24 - 18:49	06:47 - 17:25	07:10 - 17:24
17	07:17 - 17:46	06:59 - 18:12	07:29 - 19:31	06:52 - 19:50	06:27 - 20:09	06:21 - 20:24	06:32 - 20:23	06:51 - 20:00	07:07 - 19:24	07:25 - 18:48	06:48 - 17:25	07:10 - 17:25
18	07:17 - 17:47	06:58 - 18:13	07:27 - 19:32	06:51 - 19:51	06:27 - 20:10	06:21 - 20:24	06:33 - 20:22	06:51 - 19:59	07:08 - 19:23	07:25 - 18:47	06:49 - 17:24	07:11 - 17:25
19	07:17 - 17:48	06:57 - 18:14	07:26 - 19:33	06:50 - 19:51	06:26 - 20:10	06:21 - 20:25	06:34 - 20:22	06:52 - 19:58	07:08 - 19:21	07:26 - 18:46	06:50 - 17:24	07:12 - 17:26
20	07:16 - 17:49	06:56 - 18:15	07:25 - 19:33	06:49 - 19:52	06:26 - 20:11	06:21 - 20:25	06:34 - 20:21	06:52 - 19:57	07:09 - 19:20	07:27 - 18:45	06:50 - 17:24	07:12 - 17:26
21	07:16 - 17:50	06:55 - 18:15	07:24 - 19:34	06:48 - 19:52	06:25 - 20:11	06:22 - 20:25	06:35 - 20:21	06:53 - 19:56	07:10 - 19:19	07:27 - 18:44	06:51 - 17:23	07:13 - 17:27
22	07:16 - 17:51	06:54 - 18:16	07:23 - 19:34	06:47 - 19:53	06:25 - 20:12	06:22 - 20:25	06:35 - 20:20	06:53 - 19:55	07:10 - 19:18	07:28 - 18:43	06:52 - 17:23	07:13 - 17:27
23	07:15 - 17:52	06:53 - 18:17	07:21 - 19:35	06:46 - 19:54	06:24 - 20:13	06:22 - 20:25	06:36 - 20:20	06:54 - 19:54	07:11 - 19:16	07:29 - 18:42	06:53 - 17:23	07:14 - 17:28
24	07:15 - 17:52	06:52 - 18:17	07:20 - 19:36	06:45 - 19:54	06:24 - 20:13	06:22 - 20:26	06:36 - 20:19	06:55 - 19:53	07:11 - 19:15	07:29 - 18:41	06:54 - 17:22	07:14 - 17:28
25	07:15 - 17:53	06:51 - 18:18	07:19 - 19:36	06:44 - 19:55	06:23 - 20:14	06:23 - 20:26	06:37 - 20:19	06:55 - 19:51	07:12 - 19:14	07:30 - 18:40	06:55 - 17:22	07:14 - 17:29
26	07:14 - 17:54	06:50 - 18:19	07:18 - 19:37	06:43 - 19:56	06:23 - 20:14	06:23 - 20:26	06:38 - 20:18	06:56 - 19:50	07:12 - 19:13	07:31 - 18:40	06:55 - 17:22	07:15 - 17:29
27	07:14 - 17:55	06:49 - 18:20	07:17 - 19:37	06:42 - 19:56	06:23 - 20:15	06:23 - 20:26	06:38 - 20:17	06:56 - 19:49	07:13 - 19:12	07:32 - 18:39	06:56 - 17:22	07:15 - 17:30
28	07:13 - 17:56	06:48 - 18:20	07:15 - 19:38	06:41 - 19:57	06:22 - 20:15	06:24 - 20:26	06:39 - 20:17	06:57 - 19:48	07:13 - 19:10	07:32 - 18:38	06:57 - 17:22	07:16 - 17:31
29	07:13 - 17:57		07:14 - 19:39	06:40 - 19:57	06:22 - 20:16	06:24 - 20:26	06:39 - 20:16	06:57 - 19:47	07:14 - 19:09	07:33 - 18:37	06:58 - 17:22	07:16 - 17:31
30	07:12 - 17:58		07:13 - 19:39	06:40 - 19:58	06:22 - 20:17	06:24 - 20:26	06:40 - 20:15	06:58 - 19:46	07:14 - 19:08	07:34 - 18:36	06:59 - 17:22	07:16 - 17:32
31	07:12 - 17:59		07:12 - 19:40		06:22 - 20:17		06:41 - 20:15	06:58 - 19:45		07:34 - 18:35		07:16 - 17:33





# Sri Rama Jaya Niketan

(A Non Profit Organization Fed ID # 47-2362735)

5500 Queenston Blvd, Houston, Tx 77084.

Ph: 281-750-9199 | info@sriramajaya.org | www.sriramajaya.org



Sponsorships are available for Sanctums and Dieties, Flooring, Walls, Appliances, Parking Lot etc., We request your generous Donations to achieve Phase-I of Temple Construction Financial Target \$ 2M for Sponsorship details & benefits Please visit : [www.sriramajaya.org](http://www.sriramajaya.org)



*“Bhoomi Pooja” went very well on Nov 9th 2019  
It was a strange coincidence that on the same day,  
Lord Sri Rama approved the construction of  
His Temple in Ayodhya-Bharat.*

## Sri Rama Jaya Niketan Temple Phase 1 Construction Sponsorship Opportunities

Category	Bronze	Silver	Gold	Platinum
Temple	\$1,116	\$5,116	\$10,116	\$25,116
Temple Construction				✓
All Deities			✓	✓
Any one Deity		✓		
1 Construction Brick	✓			
Lifetime Membership & Nityarchana				✓
10 Years Membership & Nityarchana			✓	
5 Years Membership & Nityarchana		✓		
1 Year Membership & Nityarchana	✓			
Special Archana on festive days			✓	✓
Display Donor's Name on the Board			✓	✓

Please Write Checks  
Payable to

“Sankata Mochana Hanma”

All Sponsors of \$ 251

and Above Will Get

Sri Sankata Mochana Hanuman

“Silver Coin”

All Donations Are

Tax Deductable